

**PRINCETON PUBLIC
SCHOOLS**

REFERENDUM

**A SOUND PLAN FOR
SUSTAINABILITY, SAFETY,
STEWARDSHIP AND LEARNING**

PK - 12

Sustainability

- Select roofing replacements
- Window replacements
- Door replacements
- Gym ventilation unit replacements
- Energy-efficient gym lighting
- Sensor-controlled lighting
- Energy-saving window awnings

Safety

- Track & turf replacement
- Bleacher replacement
- Refurbished athletic fields
- Emergency generator
- ADA ramp
- Improved drainage in select areas
- Playground safety measures
- New interior fire doors
- Security equipment

Stewardship

- Brick re-pointing and waterproofing
- Gym floor replacement
- Classroom Storage
- Paved areas re-conditioned
- Select locker replacement
- Team room improvements

Learning

- Media center
- AC in second-floor classrooms
- New auditorium seating,
sound & lighting systems
- Extension of wireless networking
- Energy-efficient climate controls
- Technology infrastructure

Community Park

- Air handler: gym
- Multi-purpose room roof
- Playground rubber base
- Security equipment upgrade
- Stair tower doors
- Gym floor replacement
- Classroom cabinets, shelving
- Paving
- Extension of technology infrastructure

Johnson Park

- Air handler: gym
- Energy controls on systems
- Exterior door replacement
- Playground rubber base
- Water service upgrade
- Lower lot erosion remediation
- Drainage: Upper lot drainage improvement
- Security equipment upgrade
- Waterproof gym
- Gym floor replacement
- Classroom cabinets, shelving
- Paving
- Extension of technology infrastructure

Littlebrook

- Air handler: gym
- Exterior door replacement
- Playground rubber base
- Security equipment upgrade
- Interior door replacement
- Classroom cabinets, shelving
- Extension of technology infrastructure

Riverside

- Air handler: gym
- Exterior door replacement
- Roof/gutter replacement
- Playground rubber base
- Water service upgrade
- Security equipment upgrade
- Gym floor replacement
- Classroom cabinets, shelving
- Extension of technology infrastructure

JW Middle School

- Re-purposing of old gym into media center
- New auditorium seating and sound & lighting systems
- Energy-saving window awnings
- Emergency generator circuit
- Air-conditioning of second-floor classrooms
- Window replacement
- Roofing replacement
- Sensor controlled lighting
- Extension of technology infrastructure
- Paving
- Interior fire-door replacement

Princeton High School

- Track, turf and bleacher replacements
- Refurbished practice fields
- Select locker replacements
- Team room improvements
- Brick re-pointing and waterproofing
- Classroom renovation to create added instructional space
- New flooring, ceiling and fixtures in locker room
- ADA entrance ramp
- Energy-efficient gym lighting
- Roofing replacement
- Exterior door replacement
- Window replacement
- Refurbished baseball fields (@ VR)
- Energy efficient climate controls
- Extension of technology infrastructure
- Sensor controlled lighting

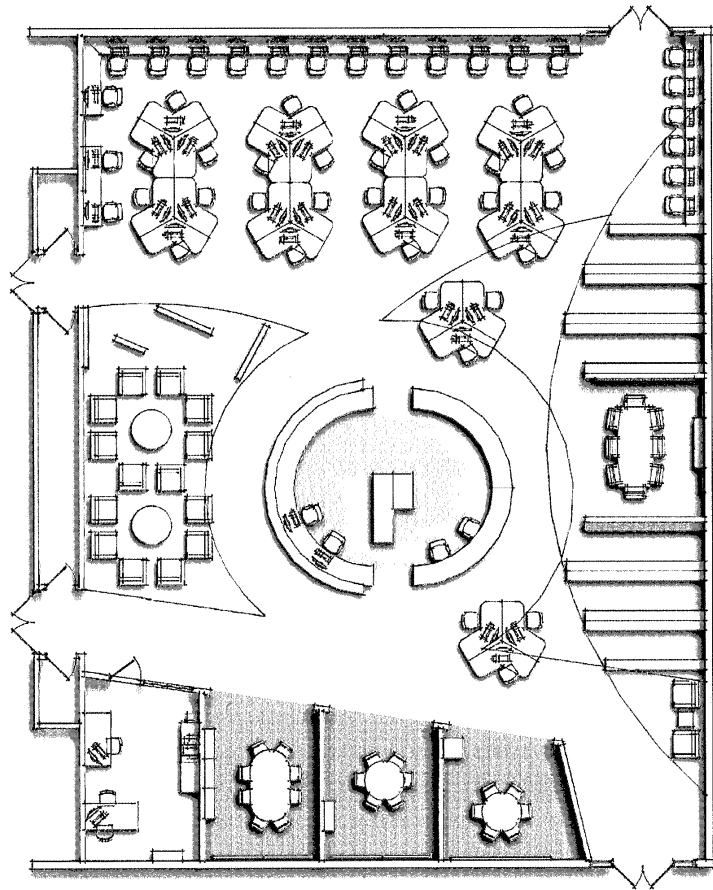

JOHN WITHERSPOON MIDDLE SCHOOL PROPOSED MEDIA CENTER CONCEPT PLAN

PRINCETON PUBLIC SCHOOLS
PRE-REFERENDUM

PRELIMINARY DESIGN AUGUST 23, 2012
SCALE: N.T.S.

ARCHITECTURE
PLANNING
DESIGN
spiegle
130 BANNICK DRIVE
MIDWICH
NEW JERSEY 08810